

AN ORDINANCE NO. \_\_\_\_\_

Accepting the application for annexation of certain territory containing 2.461 acres, more or less, in Springfield Township and commonly known as the 0 Maplewood Avenue Annexation Area to The City of Springfield, Ohio.

...oooOOOooo...

WHEREAS, a petition for the annexation of certain territory in Springfield Township was duly filed by Clayton Schrey, as Agent for Aldi Inc., on behalf of United Entertainment Corporation; and

WHEREAS, on March 19, 2025, the Board of County Commissioners of Clark County, Ohio, approved the annexation of the territory to The City of Springfield, Ohio, as hereinafter described; and

WHEREAS, the Board of County Commissioners of Clark County, Ohio, certified the transcript of the proceedings in connection with the annexation with the map and petition required in connection therewith to the City Clerk who received the same on March 25, 2025; and

WHEREAS, sixty (60) days from the date of filing have now lapsed in accordance with the provisions of Ohio Revised Code Section 709.04; NOW, THEREFORE:

BE IT ORDAINED by the City Commission of The City of Springfield, Ohio

Section 1. That the proposed annexation as applied for in the petition of Clayton Schrey, as Agent for Aldi Inc., on behalf of United Entertainment Corporation, and filed with the Board of County Commissioners of Clark County, Ohio, praying for annexation to The City of Springfield, Ohio, of certain territory adjacent thereto as hereinafter described, and which petition was approved for annexation to The City of Springfield, Ohio by the Board of County Commissioners on March 19, 2025, is hereby accepted. The territory is described in "Exhibit A" attached hereto and made a part hereof.

The certified transcript of the proceedings for annexation with an accurate map of the territory, together with the petition for its annexation, and other papers relating to the proceedings thereto of the County Commissioners are on file with the City Clerk and have been for more than sixty (60) days.

Section 2. That the City Clerk is hereby authorized and directed to make three (3) copies of this Ordinance to each of which shall be attached a copy of the map relating to the annexation proceeding, a copy of the transcript of proceedings of the Board of County Commissioners relating thereto and a certificate as to the correctness thereof. The City Clerk shall then forthwith deliver one copy to the County Auditor, one copy to the County Recorder and one copy to the Secretary of State and shall file notice of this annexation with the Board of Elections within thirty (30) days after it becomes effective, and the Clerk shall do all of the things required by law.

Section 3. In accordance with Section 1175.01 of the City's Codified Ordinances, the adjacent City C-LC, Commercial Light District zoning classification shall be assigned to the above-described annexation area, administered, and enforced by the Director of Community Development or her authorized representative on the date the annexation becomes effective. Further, the provisions of Chapter 1127 "Flood Plain Overlay District" shall also become effective and enforceable within the above-described annexation territory on the date the annexation becomes effective.

Section 4. That this Ordinance shall take effect and be in force from and after fourteen (14) days from the date of its passage.

PASSED this \_\_\_\_\_ day of \_\_\_\_\_, A.D., 2025.

\_\_\_\_\_  
PRESIDENT OF THE CITY COMMISSION

\_\_\_\_\_  
CLERK OF THE CITY COMMISSION

(Published: *Springfield News-Sun*

\_\_\_\_\_, 2025)

I do hereby certify that the foregoing Ordinance No. \_\_\_\_\_ was duly  
published in the *Springfield News-Sun* on \_\_\_\_\_,  
2025.

\_\_\_\_\_  
CLERK OF THE CITY COMMISSION

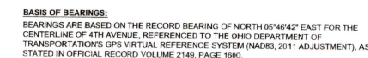
CLARK COUNTY ENGINEER'S REVISED RECORD OF LAND SURVEYS  
VOL.      PAGE

**ANNEXATION NOTE:**  
THE PERIMETER OF THE TERRITORY SHOWN HEREIN IS APPROXIMATELY 1,301.23 FEET OF WHICH APPROXIMATELY 484.48 FEET (37.2%) IS CONFIGUOUS WITH THE EXISTING CORPORATION LINE.

**PERTINENT DOCUMENTS:**  
DEED REFERENCES AS SHOWN  
PLAN REFERENCES AS SHOWN  
PLAT REFERENCES AS SHOWN  
LAND SURVEY F.B. 29 PG. 56-B PRISM SURVEYS, LLC SURVEY FOR CHACKERES THEATRE, INC.

**PRE-APPROVED**  
Not to be used for recording  
Cari County Tax Map Department  
Kenneth D. Fenton P.S. - Oct 29

**CERTIFICATION:**  
THIS MAP WAS PREPARED TO IDENTIFY A PARCEL OF LAND TO BE INCORPORATED INTO THE CITY OF SPRINGFIELD, OHIO. THE INFORMATION PRESENTED IS BASED ON RECORD INFORMATION. PERMANENT PARCEL NUMBER AND CITY OF SPRINGFIELD ARE THOSE ASSIGNED BY THE CLARK COUNTY LAND INFORMATION SYSTEMS OFFICE AS OF THE DATE OF FILING OF THIS ANNEXATION. DEED AND PLAT REFERENCES ARE FROM THE CLARK COUNTY RECORDER'S OFFICE.

DLZ OHIO, INC.

  
SAMUEL L. STILTNER  
PROFESSIONAL SURVEYOR S-836



6121 Huntley Rd. Columbus, Ohio 43229  
(614) 888-0040

\\projects\2024\2421\507300 Aul-SPR 103 Springfield\07\_survey\Boosemap\2421507300\_ALTA.dwg Oct 24 9:25 AM